

EX - PLUGS AND RECEPTACLES

10 A to 125 A
plugs and receptacles plastic version for zone 1, 2, 21 and 22

1 A good connection

Providing electrical energy there, where it is most needed – even in hazardous areas for the Zones 1, 2, 21 and 22.

Non-stationary electrical apparatus have generally high requirements on the energy/power supply. Robust plugs and receptacles as well as a high chemical resistance are at the first glance very important. Electrical reliability is a must not only for all connectivity products.

A high safety standard, a steady hold and faultless contacting even under vibration or the effects of an aggressive atmospheric environment are the basis for a secure and reliable utilisation.

CEAG plugs and receptacles offer more, apart from the proven technology, this product series is defined by its innovative details. For example, the very efficient cable strain relief or the new coding system of the various versions offers different solutions for a secure and problem free utilization in all areas.

Just to round the product off, the user in the normal industrial sector becomes exactly the same product advantages. Robust industrial versions fulfil all requirements appertaining to mechanical and chemical durability. For the stationary repair power supplying in hazardous explosive areas, there is a specially conceived version available that fulfils all the necessary safety requirements. Used in a module sense, individual solutions are no problem at all. The CEAG wall socket for instance can be mounted on to the pre-installed mounting frame without having to use tools – installation without a hot work permit.

Apart from the plugs and receptacles for the European market, we also have plugs and sockets extra for the US market, which are in accordance to all of the necessary standards UL and safety protection systems used there. The available standard range used here, are the 20 A, 30 A, 60 A and 100 A.

International approvals.

- **Nickel-plated contacts**
- **Low insertion force**
- **Safety standard IP66 applies also in the plugged-in state**
- **Full AC-3 switching ability**
- **Self-cleaning lamellar contacts, low transition resistance**
- **All-pole on/off switching**
- **Easy plugging**





Transformer plug

1

Technical data

Ex-transformer plug acc. to IEC 60309-1/2, up to 415 V	
Marking accd. to 94/9/EC	Ⓔ II 2 G Ex ed IIC T5
EC-Type Examination Certificate	PTB 99 ATEX 1039
Marking accd. to IECEx	Ex ed [ia] IIC T6/T5
IECEX Certificate of Conformity	IECEX BK1 04.0002
Permissible ambient temperature	-20 °C to + 40 °C
Rated voltage primary	250 V AC
Rated voltage secondary	12 V, 24 V, 36 V, 42 V or 230 V~
Frequency	50 - 60 Hz
Power consumption	max. 65 VA
Back up fuse, internal	0.5 A mT, replaceable
Connecting terminals	1 x 1 - 4 mm ²
Protection class	I
Degree of protection accd. to EN 60529	IP54
Cable entry	Ø 10 - 20 mm
Enclosure material	glass-fibre reinforced polyester, polyamide

Ordering details

Voltage	h	Type	Weight approx.	Sec voltage	Order No.
16 A transformer plug 4-pole					
200-250 V		Transformer plug 65 VA	2.3 kg	42 V	GHG 531 6469 V0000
		Transformer plug 65 VA	2.3 kg	24 V	GHG 531 6469 V5005
		Transformer plug 65 VA	2.3 kg	12 V	GHG 531 6469 V5025
16 A transformer plug 5-pole					
380-415 V		Transformer plug 65 VA	2.3 kg	42 V	GHG 531 6566 V0000
		Transformer plug 65 VA	2.3 kg	24 V	GHG 531 6566 V5005
		Transformer plug 65 VA	2.3 kg	12 V	GHG 531 6566 V5025
		Transformer plug 65 VA	2.3 kg	230 V	GHG 531 6566 V5023
Plug with fuse					
200-250 V		Plug with fuse max. 6.3 A	1.3 kg	-	GHG 531 7536 V0000
Accessories					
Plug cap 3/4 pole					GHG 530 1935 R0002
Plug cap 5 pole / Plug with fuse					GHG 530 1935 R0005

Dimension drawing

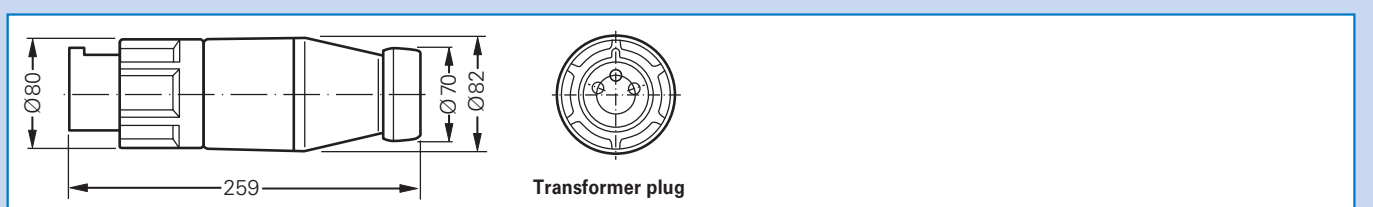

Transformer plug

Dimensions in mm

16 A 3-pole, 4-pole and 5-pole up to 690 V



Technical data

Ex-plugs and receptacles acc. to IEC 60309-1/2 16A	
Marking accd. to 94/9/EC	Ⓔ II 2 G Ex ed IIC T6 / Ⓔ II 2 D Ex tD A21 IP66 T80 °C
EC-Type Examination Certificate	Wall socket, plug and coupler: PTB 99 ATEX 1039 Flange socket: PTB 99 ATEX 1040 U
IECEX Certificate of Conformity	IECEX BKI 04.0002
Marking accd. to IECEx	Ex ed [ia] IIC T6/T5
Permissible ambient temperature	-20°C up to +40°C ¹⁾
Rated voltage	up to 400 V, (3-pole) / 690 V, (4-pole) / 500 V, (5-pole) AC
Rated current	16 A
Frequency	up to 400 Hz
Rated making / Rated breaking capacity AC-3 accd. EN 60947-3	U _o 250 V / I _o 16 A (3-pole) U _o 690 V / I _o 16 A (4-pole) U _o 500 V / I _o 16 A (5-pole)
External back-up fuse, max.	without therm. protection: 16 A with therm. protection: 35 A gL (rated current 16 A set to)
Protection class	I
Degree of protection accd. to EN 60529	IP66

Wall socket	
Cable entry	1 x M25 Ø 8 - 17 mm, 1 x M25 plastic Ex-screw plug or 2 x metal thread M20 with plastic Ex-screw plug
Connecting terminals	2 x 1 - 4 mm ²
Enclosure material	glass-fibre reinforced polyester

Plug	
Cable entry	Ø 8 - 19 mm (3-pole) / Ø 8 - 21 mm (4-pole) / 12 - 21 mm (5-pole)
Connecting terminals	1 x 1.0 - 2.5 mm ²
Enclosure material	Polyamide

Coupler	
Cable entry	Ø 8 - 19 mm (3-pole) / Ø 8 - 21 mm (4-pole) / 12 - 21 mm (5-pole)
Connecting terminals	2 x 1 - 4 mm ²
Enclosure material	Polyamide

Flange socket	
Connecting terminals	2 x 1 - 4 mm ²
Enclosure material	Polyamide

1) extended temperature range on request

Ordering details

Voltage	h	Type	Aux. contact	Cable entry	Weight approx.	Order No.
Type 16 A 3-pole						
110-130 V		Wall socket	-	M25 KU	1.2 kg	GHG 511 4304 R0001
		Wall socket	-	M20 GE	1.2 kg	GHG 511 4304 R0002
		Wall socket	-	M20 ME	1.3 kg	GHG 511 4304 R3001
		Wall socket	-	M20 GM	1.3 kg	GHG 511 4304 R3003
		Flange socket	-	-	0.4 kg	GHG 511 8304 R0001
		Coupler	-	-	0.7 kg	GHG 511 3304 R0001
		Plug	-	-	0.35 kg	GHG 511 7304 R0001



Ordering details

Voltage	h	Type	Aux. contact	Cable entry	Weight approx.	Order No.
Type 16 A 3-pole						
200-250 V		Wall socket	–	KU	1.2 kg	GHG 511 4306 R0001
		Wall socket	–	GE	1.2 kg	GHG 511 4306 R0002
		Wall socket	–	ME	1.3 kg	GHG 511 4306 R3001
		Wall socket	–	GM	1.3 kg	GHG 511 4306 R3003
		Flange socket	–		0.4 kg	GHG 511 8306 R0001
		Coupler	–		0.7 kg	GHG 511 3306 R0001
		Plug	–		0.35 kg	GHG 511 7306 R0001

Type 16 A 4-pole						
200-250 V		Wall socket	–	KU	1.8 kg	GHG 511 4409 R0001
		Wall socket	–	ME	1.9 kg	GHG 511 4409 R3001
		Wall socket	–	GM	2.0 kg	GHG 511 4409 R3003
		Flange socket	–		1.0 kg	GHG 511 8409 R0001
		Coupler	–		1.7 kg	GHG 511 3409 R0001
		Plug	–		0.7 kg	GHG 511 7409 R0001
		380-415 V		Wall socket	–	KU
Wall socket	–			ME	1.9 kg	GHG 511 4406 R3001
Wall socket	–			GM	2.1 kg	GHG 511 4406 R3003
Wall socket	yes			KH	1.8 kg	GHG 511 4406 R0501
Flange socket	–				1.0 kg	GHG 511 8406 R0001
Coupler	–				1.7 kg	GHG 511 3406 R0001
Plug	–				0.7 kg	GHG 511 7406 R0001
480-500 V		Wall socket	–	KU	1.8 kg	GHG 511 4407 R0001
		Wall socket	–	ME	1.9 kg	GHG 511 4407 R3001
		Wall socket	yes	KH	1.8 kg	GHG 511 4407 R0501
		Flange socket	–		1.0 kg	GHG 511 8407 R0001
		Coupler	–		1.7 kg	GHG 511 3407 R0001
		Plug	–		0.7 kg	GHG 511 7407 R0001
		600-690 V		Wall socket	–	KU
Wall socket	–			ME	1.9 kg	GHG 511 4405 R3001
Wall socket	yes			KH	1.8 kg	GHG 511 4405 R0501
Flange socket	–				1.0 kg	GHG 511 8405 R0001
Coupler	–				1.7 kg	GHG 511 3405 R0001
Plug	–				0.7 kg	GHG 511 7405 R0001

Type 16 A 5-pole						
200-250 V 380-415 V		Wall socket	–	KU	1.8 kg	GHG 511 4506 R0001
		Wall socket	–	ME	1.9 kg	GHG 511 4506 R3001
		Wall socket	yes	KH	1.8 kg	GHG 511 4506 R0501
		Wall socket	–	GM	2.1 kg	GHG 511 4506 R3003
		Flange socket	–		1.0 kg	GHG 511 8506 R0001
		Coupler	–		1.7 kg	GHG 511 3506 R0001
		Plug	–		0.7 kg	GHG 511 7506 R0001

Other voltage ranges and versions available on request

KU = 1 x plastic cable glands M25 for Ø 8 -17 mm, 1 x M25 plastic Ex-screw plug

KH = 2 x plastic cable glands M25 for Ø 8 - 17 mm, aux. contact, 1 NO

ME = 2 x metal thread M20

GE = 2x plastic thread M20 without gland/screw plug

GM = 2 x metal thread M20 with screw plug, with external earth bolt M6

16A 3-pole, 4-pole and 5-pole up to 690 V



Dimension drawing | Wiring diagram

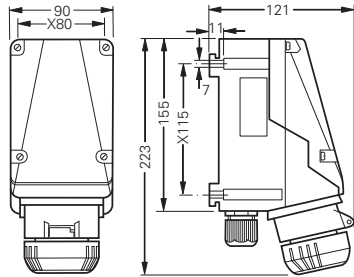

Wall socket 3-pole

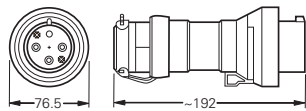

Plug 3-pole

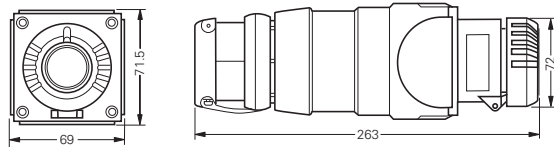

Coupler 3-pole

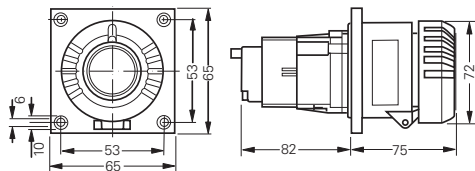

Flange socket 3-pole

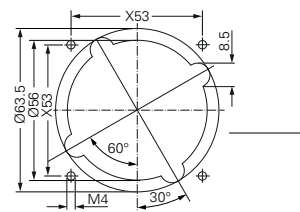

Assembly dimensions flange socket

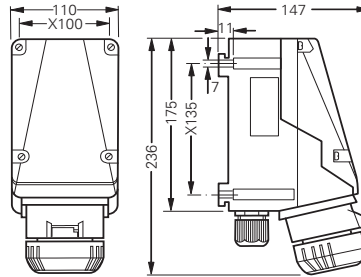

Wall socket 4/5-pole

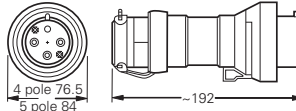

Plug 4/5-pole

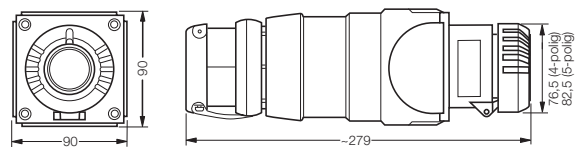

Coupler 4/5-pole

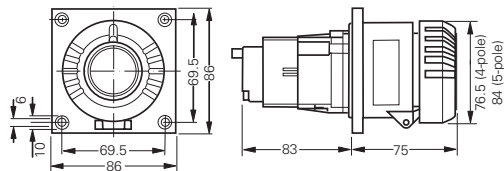

Flange socket 4/5-pole

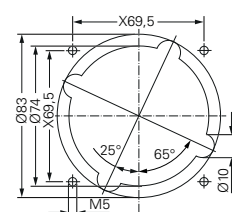

Assembly dimensions flange socket X = fixing dimensions

without aux. contact

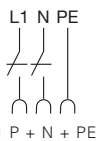

without aux. contact

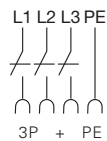

with aux. contact

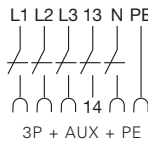

without aux. contact

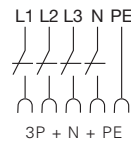

with aux. contact

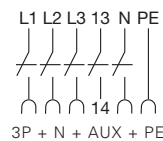

Dimensions in mm

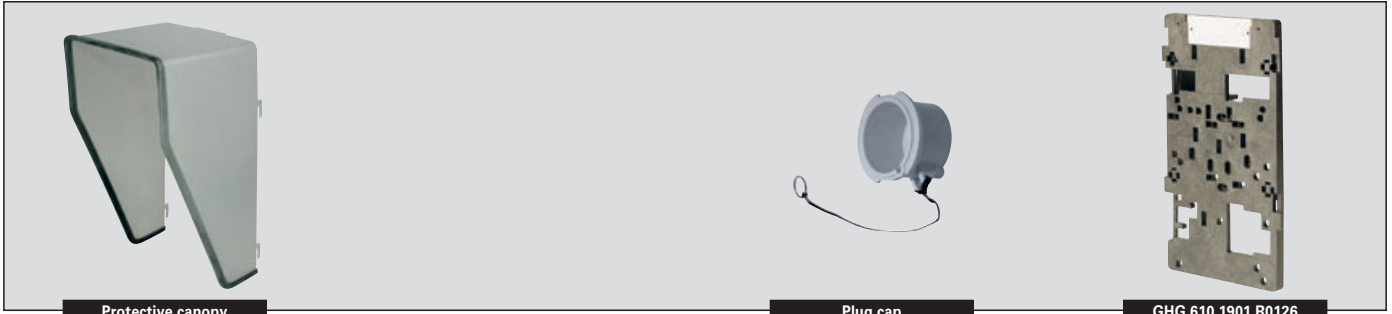

1

Accessories

Mounting plates for wall sockets 16 A

Type	Application	Fixing method	Order No.
Size 4	for wall mounting	snap on	GHG 610 1953 R0126
Size 4	for trellis mounting	snap on	GHG 610 1953 R0126
Size 4	for pipe clamp	snap on	GHG 610 1953 R0130

Plug cap for plugs 16 A

Type	Order No.
Plug 16 A 3-pole	GHG 510 1901 R0001
Plug 16 A 4-pole	GHG 510 1901 R0002
Plug 16 A 5-pole	GHG 510 1901 R0003

Accessories for mounting plates

Type	OU	Order No.
Mounting set for pipes 1" (Ø 27 - 30 mm) for mounting plates with pipe fixing	10	GHG 610 1953 R0020

Please pay attention that only order units (OU) according to the ordering details can be delivered.

Protective canopy for mounting plate

Type	Application	Order No.
Size 4	for mounting plate size 4, snap on	GHG 610 1955 R0107

Dimension drawing

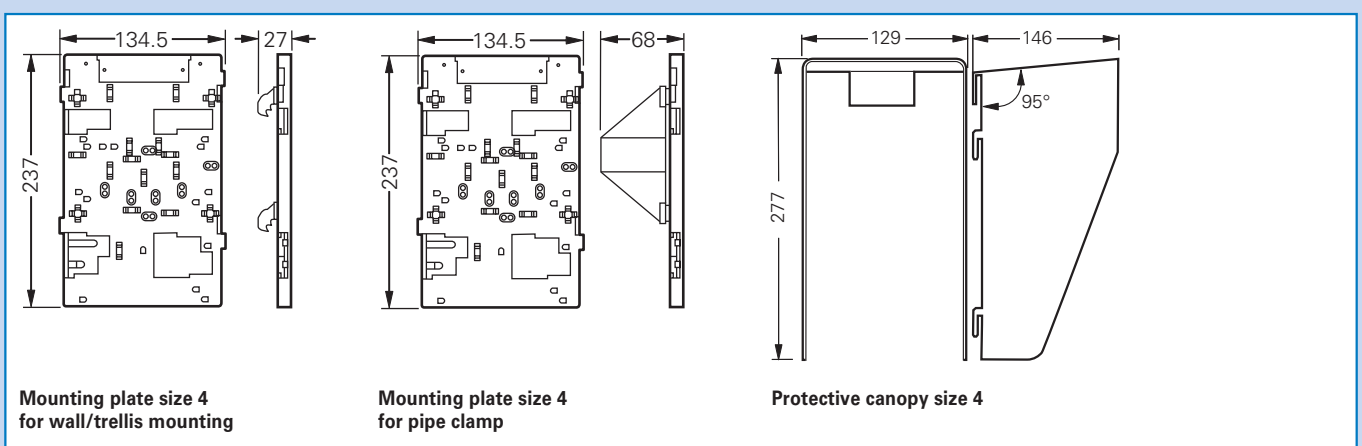

Dimensions in mm

| 32A 4-pole up to 690 V |
| 32A 5-pole up to 415 V |



Wall socket



Flange socket



Coupler



Plug

Technical data

Ex-plugs and receptacles acc. to IEC 60309-1/2

Marking accd. to 94/9/EC	⊕ II 2 G Ex de (ia) IIC T6 / ⊕ II 2 D Ex tD A21 IP66 T80 °C
EC-Type Examination Certificate	Wall socket, plug and coupler: PTB 99 ATEX 1041 Flange socket: PTB 99 ATEX 1042 U
IECEX Certificate of Conformity	IECEX BKI 04.0006
Marking accd. to IECEx	Ex ed [ia] IIC T6/T5
Permissible ambient temperature	-20 °C to +40 °C ¹⁾
Rated voltage	up to 690 V (AC)
Rated current	32 A
Frequency	up to 400 Hz
Rated making / Rated breaking capacity AC-3 accd. EN 60947-3	U ₀ 690 V / I ₀ 32 A
External back up fuse	without therm. protection: 35 A with therm. protection: 50 A gL (rated current 32 A set to)
Protection class	I
Degree of protection accd. to EN 60529	IP66
Enclosure colour	black

Wall socket

Cable entry/enclosure drilling	1 x M40 Ø 17 - 28 mm, 1 x M40 plastic Ex-screw plug or 2 x M32 metal thread with 2 plastic Ex-screw plug
Connecting terminals	2 x 4 - 10 mm ²
Enclosure material	glass-fibre reinforced polyester

Plug

Cable entry	Ø 17 - 28 mm
Connecting terminals	1.0 - 6 mm ²
Enclosure material	Polyamide

Coupler

Cable entry	Ø 17 - 28 mm
Connecting terminals	2 x 4 - 10 mm ²
Enclosure material	Polyamide

Flange socket

Connecting terminals	2 x 4 - 10 mm ²
Enclosure material	Polyamide

1) extended temperature range on request



Ordering details

Voltage	h	Type	Aux. contact	Cable entry	Weight approx.	Order No.
Type 32 A 4-pole						
200-250 V		Wall socket	–	KU	1.8 kg	GHG 512 4409 R0001
		Wall socket	–	ME	1.9 kg	GHG 512 4409 R3001
		Wall socket	–	GM	2.0 kg	GHG 512 4409 R3003
		Flange socket			1.0 kg	GHG 512 8409 R0001
		Coupler			1.7 kg	GHG 512 3409 R0001
		Plug			0.7 kg	GHG 512 7409 R0001
380-415 V		Wall socket	–	KU	1.8 kg	GHG 512 4406 R0001
		Wall socket	–	ME	1.9 kg	GHG 512 4406 R3001
		Wall socket	yes	KH	1.8 kg	GHG 512 4406 R0501
		Wall socket	–	GM	2.0 kg	GHG 512 4406 R3003
		Flange socket			1.0 kg	GHG 512 8406 R0001
		Coupler			1.7 kg	GHG 512 3406 R0001
480-500 V		Wall socket	–	KU	1.8 kg	GHG 512 4407 R0001
		Wall socket	–	ME	1.9 kg	GHG 512 4407 R3001
		Wall socket	yes	KH	1.8 kg	GHG 512 4407 R0501
		Flange socket			1.0 kg	GHG 512 8407 R0001
		Coupler			1.7 kg	GHG 512 3407 R0001
		Plug			0.7 kg	GHG 512 7407 R0001
600-690 V		Wall socket	–	KU	1.8 kg	GHG 512 4405 R0001
		Wall socket	–	ME	1.9 kg	GHG 512 4405 R3001
		Wall socket	yes	KH	1.8 kg	GHG 512 4405 R0501
		Flange socket			1.0 kg	GHG 512 8405 R0001
		Coupler			1.7 kg	GHG 512 3405 R0001
		Plug			0.7 kg	GHG 512 7405 R0001
Type 32 A 5-pole						
200-250 V		Wall socket	–	KU	1.8 kg	GHG 512 4506 R0001
380-415 V		Wall socket	–	ME	1.9 kg	GHG 512 4506 R3001
		Wall socket	yes	KH	1.8 kg	GHG 512 4506 R0501
		Wall socket	–	GM	2.0 kg	GHG 512 4506 R3003
		Flange socket			1.0 kg	GHG 512 8506 R0001
		Coupler			1.7 kg	GHG 512 3506 R0001
6 h	Plug			0.7 kg	GHG 512 7506 R0001	

Other voltage ranges and versions available on request

KU = 1 x plastic cable glands M40 for Ø 17-28 mm, 1 x M40 plastic Ex-screw plug

KH = 1 x plastic cable glands M40 for Ø 17-28 mm,

1 x plastic cable glands M25 for Ø 8 - 17 mm, with aux. contact

ME = 2 x metal thread M32 with plastic Ex-screw plug

GM = 2 x metal thread M32 with screw plug, with external earth bolt M6

32A 4-pole up to 690 V

32A 5-pole up to 415 V



Wall socket



Flange socket



Coupler



Plug

Dimension drawing | Wiring diagram

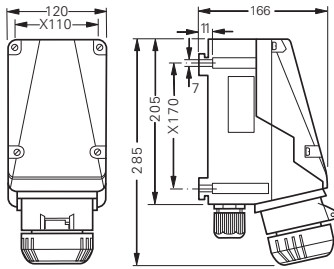

Wall socket 4-pole

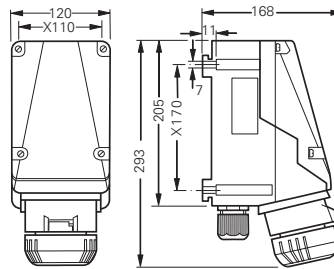

Wall socket 5-pole

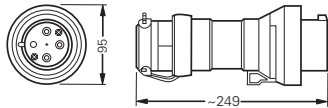

Plug 4-pole

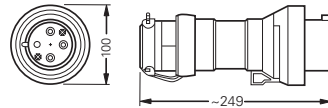

Plug 5-pole

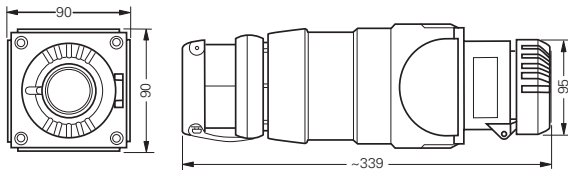

Coupler 4-pole

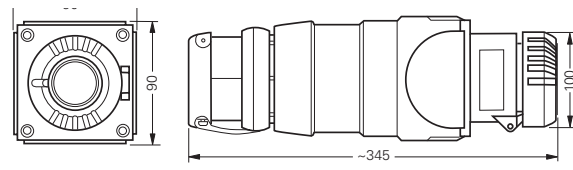

Coupler 5-pole

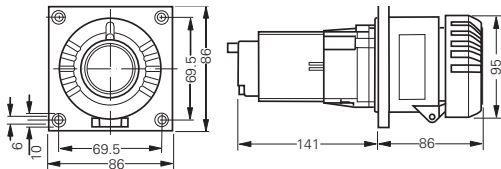

Flange socket 4-pole

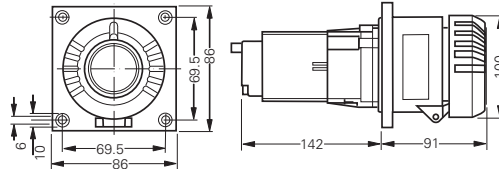

Flange socket 5-pole

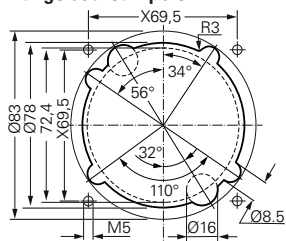

Assembly dimensions flange socket

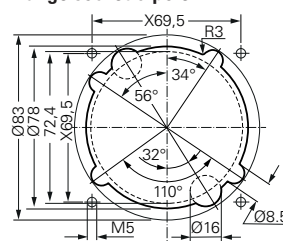

Assembly dimensions flange socket

X = fixing dimensions

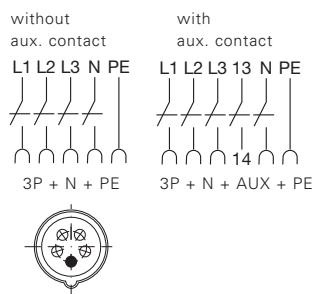
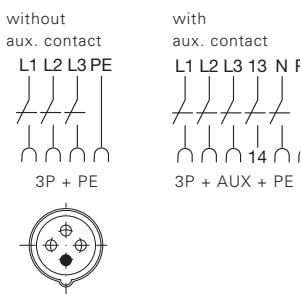

Dimensions in mm

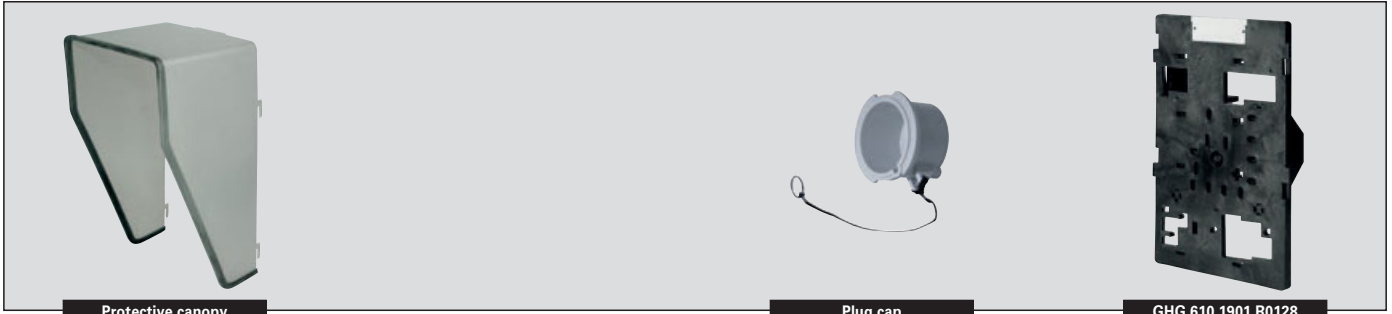

Protective canopy

Plug cap

GHG 610 1901 R0128

Accessories

Mounting plates for wall sockets 32 A

Type	Application	Fixing method	Order No.
Size 5	for wall mounting	snap on	GHG 610 1953 R0128
Size 5	for trellis mounting	snap on	GHG 610 1953 R0128
Size 5	for pipe clamp	snap on	GHG 610 1953 R0132

Plug cap for plugs 32 A

Type	Order No.
Plug 32 A 3-pole/4-pole	GHG 510 1901 R0004
Plug 32 A 5-pole	GHG 510 1901 R0005

Accessories for mounting plates

Type	OU	Order No.
Mounting set for pipes 1" (Ø 27 - 30 mm) for mounting plates with pipe fixing	10	GHG 610 1953 R0020

Please pay attention that only order units (OU) according to the ordering details can be delivered.

Protective canopy for mounting plate

Type	Application	Order No.
Size 5	for mounting plate size 5, snap on	GHG 610 1955 R0108

Dimension drawing

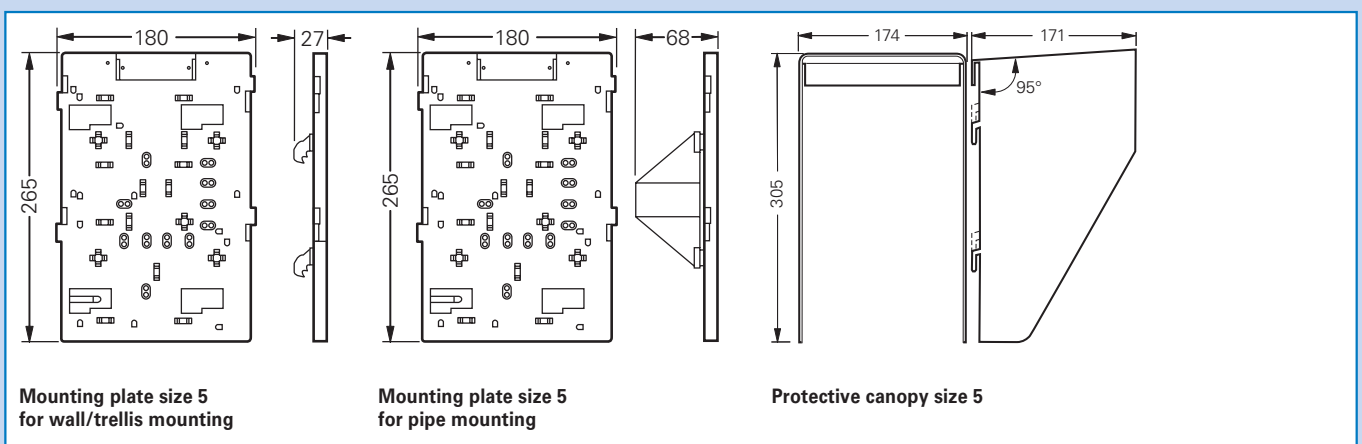

32A 4-/5-pole transformer plug
Plug with fuse



Transformer plug



Plug cap

Technical data

Ex-transformer plug acc. to IEC 60309-1/2, up to 415 V

Marking accd. to 94/9/EC	⊕ II 2 G Ex de IIC T5
EC-Type Examination Certificate	PTB 99 ATEX 1041
IECEX Certificate of Conformity	IECEX BKI 04.0006
Marking accd. to IECEx	Ex ed [ia] IIC T6/T5
Permissible ambient temperature	-20 °C to +40 °C
Rated voltage primary	250 V AC
Rated voltage secondary	24 V, 36 V or 42 V/230 V AC
Frequency	50/60 Hz
Power consumption	max. 65 VA
Back up fuse, internal	0.5 A mT, replaceable
Connecting terminals	1 x 1 - 4 mm ²
Protection class	I
Degree of protection accd. to EN 60529	IP54
Enclosure material	glass-fibre reinforced polyester, polyamide

Ordering details

Voltage	h	Type	Weight approx.	Sec voltage	Order No.
32 A transformer plug 4-pole					
200-250 V	 9 h	Transformer plug 65 VA	2.3 kg	42 V	GHG 532 6469 V0000
		Transformer plug 65 VA	2.3 kg	24 V	GHG 532 6469 V5005
32 A transformer plug 5-pole					
380-415 V	 6 h	Transformer plug 65 VA	2.3 kg	42 V	GHG 532 6566 V0000
		Transformer plug 65 VA	2.3 kg	24 V	GHG 532 6566 V5005
		Transformer plug 65 VA	2.3 kg	12 V	GHG 532 6566 V5025
		Transformer plug 65 VA	2.3 kg	230 V	GHG 532 6566 V5023
Plug with fuse					
200-250 V	 6 h	Plug with fuse max. 6.3 A	1.3 kg		GHG 532 7536 V0000
Accessories					
Plug cap 4 pole					GHG 530 1935 R0002
Plug cap 5 pole / plug with fuse					GHG 530 1935 R0005



1

Transformer plug

Dimension drawing

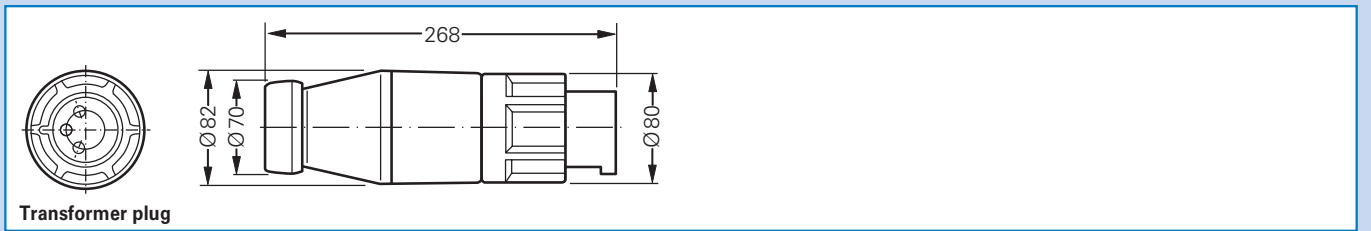

Dimensions in mm

63 A 4- and 5-pole up to 690 V



Wall socket



Plug

Technical data

Ex-plugs and receptacles acc. to IEC 60309-1/2

Marking accd. to 94/9/EC	⊕ II 2 G Ex de IIC T5/T6 / ⊕ II 2 D Ex tD A21 IP66 T80 °C
EC-Type Examination Certificate	PTB 00 ATEX 1070
IECEX Certificate of Conformity	IECEX BKI 04.0004
Marking accd. to IECEX	Ex ed IIC T6
Permissible ambient temperature	-20 °C to +40 °C ¹⁾
Rated voltage	690 V (AC)
Rated current	63 A
Frequency	up to 400 Hz
Rated making / Rated breaking capacity AC-3 accd. EN 60947-3	U _e 690 V / I _e 63 A
External back up fuse	without therm. protection: 63 A with therm. protection: 80 A gL (rated current 63 A set to)
Protection class	I
Degree of protection accd. to EN 60529	IP66
Enclosure colour	black

Wall socket

Cable entry/enclosure drilling	1 x M50 Ø 22 - 35 mm, 1 x M50 plastic Ex-screw plug or 2 x M40 metal thread with 2 plastic Ex-screw plug
Connecting terminals	2 x 4 - 25 mm ² / with ring cable lug ²⁾ 1 x 35 mm ²
Enclosure material	glass-fibre reinforced polyester

Plug

Cable gland	Ø 19 - 34 mm
Connecting terminals	1 x 4 - 16 mm ² , with cable lug ³⁾ 1 x 25 mm ²
Enclosure material	Polyamide

¹⁾ extended temperature range on request



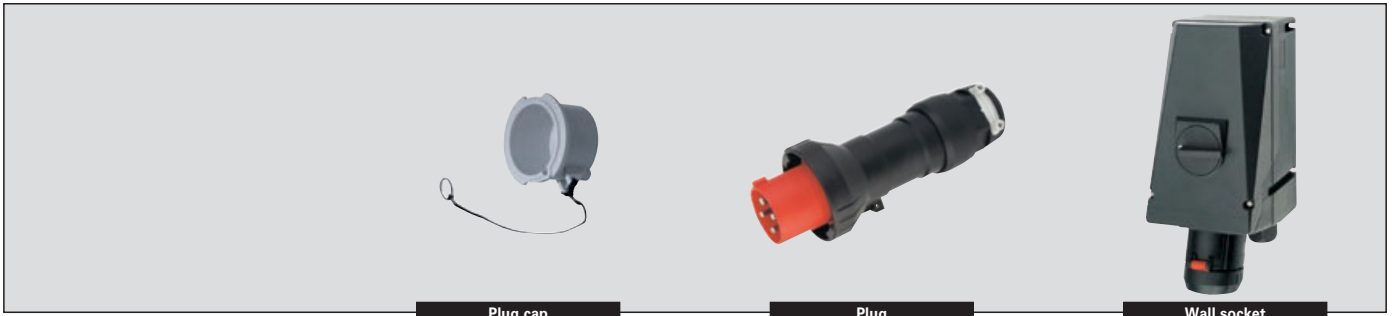

²⁾ use supplied cable lugs

³⁾ see accessories



1

Ordering details

Voltage	h	Type	Aux. contact	Cable entry	Weight approx.	Order No.
Type 63 A 4-pole						
200-250 V		Wall socket	–	KU	8.1 kg	GHG 514 4409 R0001
		Wall socket	–	ME	8.2 kg	GHG 514 4409 R3001
		Plug	–		0.75 kg	GHG 514 7409 R0001
380-415 V		Wall socket	–	KU	8.1 kg	GHG 514 4406 R0001
		Wall socket	–	ME	8.2 kg	GHG 514 4406 R3001
		Wall socket	yes	KH	8.2 kg	GHG 514 4406 R0501
		Wall socket	–	GM	8.2 kg	GHG 514 4406 R3017
		Plug	–		0.75 kg	GHG 514 7406 R0001
480-500 V		Wall socket	–	KU	8.1 kg	GHG 514 4407 R0001
		Wall socket	–	ME	8.2 kg	GHG 514 4407 R3001
		Wall socket	yes	KH	8.2 kg	GHG 514 4407 R0501
		Wall socket	–	GM	8.2 kg	GHG 514 4407 R3003
		Plug	–		0.75 kg	GHG 514 7407 R0001
600-690 V		Wall socket	–	KU	8.1 kg	GHG 514 4405 R0001
		Wall socket	–	ME	8.1 kg	GHG 514 4405 R3001
		Wall socket	yes	KH	8.2 kg	GHG 514 4405 R0501
		Wall socket	–	GM	8.2 kg	GHG 514 4405 R3002
		Plug	–		0.75 kg	GHG 514 7405 R0001
Type 63 A 5-pole						
200-250 V		Wall socket	–	KU	8.1 kg	GHG 514 4506 R0001
380-415 V		Wall socket	–	ME	8.1 kg	GHG 514 4506 R3001
		Wall socket	yes	KH	8.2 kg	GHG 514 4506 R0501
		Wall socket	–	GM	8.2 kg	GHG 514 4506 R3018
		Plug	–		0.75 kg	GHG 514 7506 R0001

Accessories

Type	OU	Order No.
Set of ring cable lugs 35/70 mm ² for wall socket (6 + 2 pcs.)	1	GHG 510 1916 R0001
Plug cap 4-pole/5-pole	1	GHG 510 1901 R0006
Set of cable lugs 35 mm ² (5 pcs., for plug)	5	GHG 510 1916 R0001

Other voltage ranges and versions available on request

KU = 1 x plastic cable glands M50 for Ø 22-35 mm, 1 x M50 plastic Ex-screw plug

KH = 1 x plastic cable glands M50 for Ø 22-35 mm,

1 x plastic cable glands M25 for Ø 8 - 17 mm, with aux. contact

ME = 2 x metal thread M40 with plastic Ex-screw plug

GM = 2 x metal thread M40 with screw plug M40 with external earth bolt M8

| 63 A 4- and 5-pole up to 690 V |

1



Wall socket



Plug

Dimension drawing | Wiring diagram

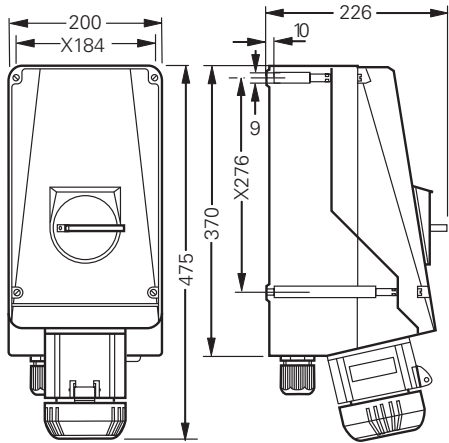

Wall socket 4/5-pole

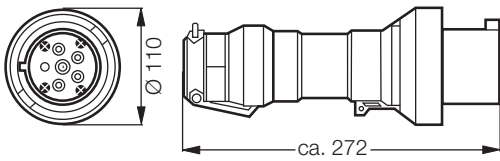

Plug 4/5-pole

X = fixing dimensions

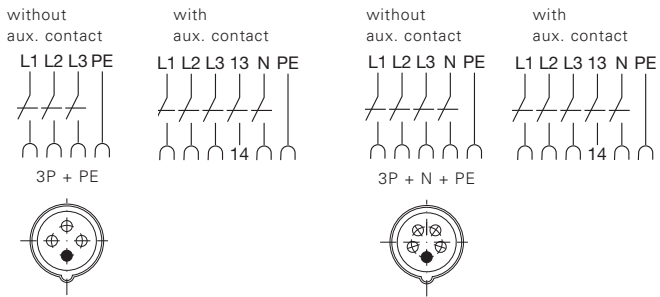

Dimensions in mm



Plug

Wall socket

1

Technical data

Ex-plugs and receptacles acc. to IEC 60309-1/2

Marking accd. to 94/9/EC	⊕ II 2 G Ex de IIC T6 / ⊕ II 2 D Ex tD A21 IP66 T80 °C
EC-Type Examination Certificate	PTB 01 ATEX 1069
IECEX Certificate of Conformity	IECEX BK1 04.0005
Marking accd. to IECEx	Ex ed IIC T6
Permissible ambient temperature	-20 °C to + 40 °C ¹⁾
Rated voltage	690 V
Rated current	125 A
Frequency	up to 400 Hz
Rated making / Rated breaking capacity AC-3 accd. EN 60947-3	U _e 690 V / I _e 125 A
External back up fuse	without therm. protection: 125 A with therm. protection: 160 A gL (rated current 125 A set to)
Protection class	I
Degree of protection accd. to EN 60529	IP66
Enclosure colour	black

Wall socket

Cable entry/enclosure drilling	1 x M63 Ø 27 - 48 mm, 1 x M63 plastic Ex-screw plug or 2 x M50 metal thread with 2 plastic Ex-screw plug
Connecting terminals	2 x 4 - 70 mm ² / with ring cable lug ²⁾ 1 x 120 mm ²
Enclosure material	glass-fibre reinforced polyester

Plug

Cable entry	Ø 31 - 55 mm
Connecting terminals	1 x 4 - 35 mm ² / with pin cable lug ³⁾ 1 x 50 mm ²
Enclosure material	Polyamide

¹⁾ extended temperature range on request

²⁾ use supplied cable lugs

³⁾ see accessories

125A 4- and 5-pole up to 690 V

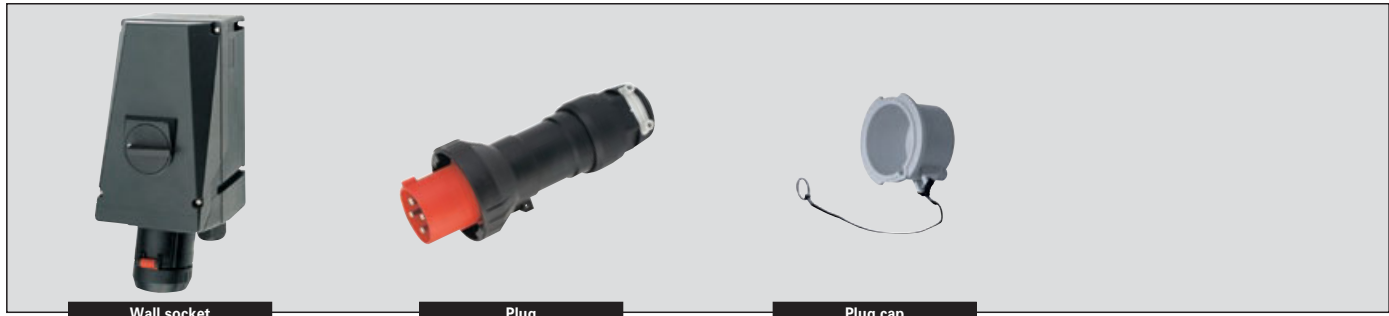

Wall socket

Plug

Plug cap

Ordering details

Voltage	h	Type	Aux. contact	Cable entry	Weight approx.	Order No.
Type 125 A 4-pole						
200-250 V		Wall socket	-	KU	12.3 kg	GHG 515 4409 R0001
		Wall socket	-	ME	12.5 kg	GHG 515 4409 R3001
		Wall socket	yes	KH	12.5 kg	GHG 515 4409 R0501
		Plug	-	-	0.9 kg	GHG 515 7409 R0001
380-415 V		Wall socket	-	KU	12.3 kg	GHG 515 4406 R0001
		Wall socket	-	ME	12.5 kg	GHG 515 4406 R3001
		Wall socket	yes	KH	12.5 kg	GHG 515 4406 R0501
		Wall socket	-	GM	8.2 kg	GHG 515 4406 R3003
		Plug	-	-	0.9 kg	GHG 515 7406 R0001
480-500 V		Wall socket	-	KU	12.3 kg	GHG 515 4407 R0001
		Wall socket	-	ME	12.5 kg	GHG 515 4407 R3001
		Wall socket	yes	KH	12.5 kg	GHG 515 4407 R0501
		Wall socket	-	GM	8.2 kg	GHG 515 4407 R3002
		Plug	-	-	0.9 kg	GHG 515 7407 R0001
600-690 V		Wall socket	-	KU	12.3 kg	GHG 515 4405 R0001
		Wall socket	-	ME	12.5 kg	GHG 515 4405 R3001
		Wall socket	yes	KH	12.5 kg	GHG 515 4405 R0501
		Wall socket	-	GM	8.2 kg	GHG 515 4405 R3002
		Plug	-	-	0.9 kg	GHG 515 7405 R0001

Type 125 A 5-pole						
200-250 V 380-415 V		Wall socket	-	KU	13.0 kg	GHG 515 4506 R0001
		Wall socket	-	ME	13.2 kg	GHG 515 4506 R3001
		Wall socket	yes	KH	13.2 kg	GHG 515 4506 R0501
		Wall socket	-	GM	8.2 kg	GHG 515 4506 R3005
		Plug	-	-	1.2 kg	GHG 515 7506 R0001

Accessories

Type	OU	Order No.
Plug cap 4-pole/5-pole	1	GHG 510 1901 R0007
Set of ring cable lug 70/120 mm ² for wall socket (je 4 + 1 pcs.)	1	GHG 260 1911 R0004
Set of cable lugs 50 mm ² (5 pcs., for plug)	5	GHG 510 1916 R0002

Other voltage ranges and versions available on request

KU = 1 x plastic cable glands M63 for Ø 27-48 mm, 1 x M40 plastic Ex-screw plug

KH = 1 x plastic cable glands M63 for Ø 27-48 mm,

1 x plastic cable glands M25 for Ø 8 - 17 mm, with aux. contact

ME = 2 x metal thread M50 with plastic Ex-screw plug

GM = 2 x metal thread M50 with screw plug, with external earth bolt M8



Plug



Wall socket

1

Dimension drawing | Wiring diagram

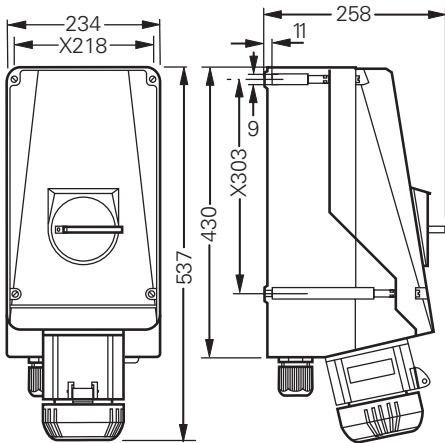

Wall socket 4/5-pole

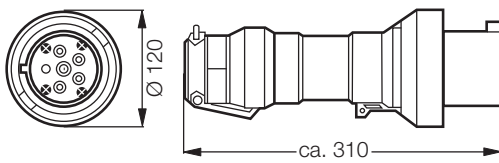

Plug 4/5-pole

X = fixing dimensions

without aux. contact

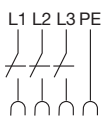

3P + PE



with aux. contact

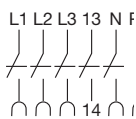

3P + AUX + PE

without aux. contact

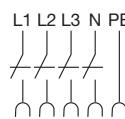

3P + N + PE



with aux. contact

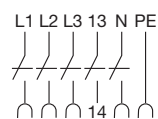

3P + N + AUX + PE

EX - PLUG AND RECEPTACLE

16 A Metal design for zone 1 and 2

1 The explosion-protected light metal plug and receptacle devices can be used in the areas of Zone 1 and Zone 2 at no risk of explosion. Extremely harsh conditions of use in the hazardous area requires the devices to have highest mechanical strength. The explosion-protected CEAG plug and socket devices can be used to supply the appropriate energy to portable electrical equipment in these harsh conditions.

The robust plug and receptacle devices with high-quality cast aluminium housings can be connected to a large connecting room via explosion-proof conduits or explosion-proof screwed connections.

Unused flameproof threads for cable glands have to be closed with certified plugs.

The light metal plug and socket devices have an outside earthing connection.

The explosion-protected plug can be plugged into an industrial sockets if their contact disposability is acc. to IEC 60309 connecting terminals are in an Ex-e chamber, all other parts are Ex-d protected.



- Ex-d enclosure
- High mechanical, chemical and thermal resistance conduit
- Connecting technology

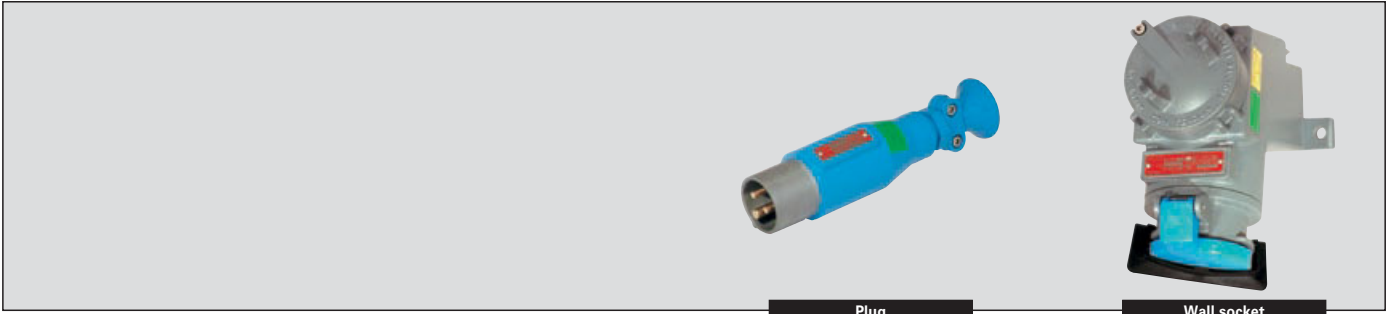

Plug

Wall socket

1

Technical data

Ex-d plugs and receptacles 16 A

Marking accd. to 94/9/EC	⊕ II 2 G Ex de IIC T6
EC-Type Examination Certificate	LOM 03 ATEX 2019
Permissible ambient temperature	-20 °C to +55 °C ¹⁾
Rated voltage	see ordering details
Rated current	16 A
Frequency	50/60 Hz
Rated making / Rated breaking capacity AC-3 accd. EN 60947-3	U _e 415 V / I _e 16 A
External back-up fuse, max.	without therm. protection: 16 A / with therm. protection: 35 A gL
Degree of protection accd. to EN 60529	IP65
Enclosure material	light alloy, polyester powder coated

Wall socket

Cable entry	2 x 3/4", ISO 7/1, one plugged
Connecting terminals	2 x 1.0 - 2.5 mm ²

Plug

Cable entry	Ø 8.5 - 13.5 mm
Connecting terminals	1 x 1.0 - 2.5 mm ² / PE: 1 x 1.5 - 6 mm ²

1) extended temperature range on request

Ordering details

Voltage ¹⁾	h	Type	Weight approx.	Order No.
Type 16 A 3-pole				
220 - 250 V	6	Wall socket	2.7 kg	NOR 000 003 230 016
	6	Plug	0.55 kg	NOR 000 003 230 058
Type 16 A 4-pole				
380 - 415 V	6	Wall socket	2.7 kg	NOR 000 003 230 024
	6	Plug	0.55 kg	NOR 000 003 230 066
Type 16 A 5-pole				
380 - 415 V	6	Wall socket	2.7 kg	NOR 000 003 230 032
	6	Plug	0.7 kg	NOR 000 003 230 074

¹⁾ other voltage ranges on request

Dimension drawing

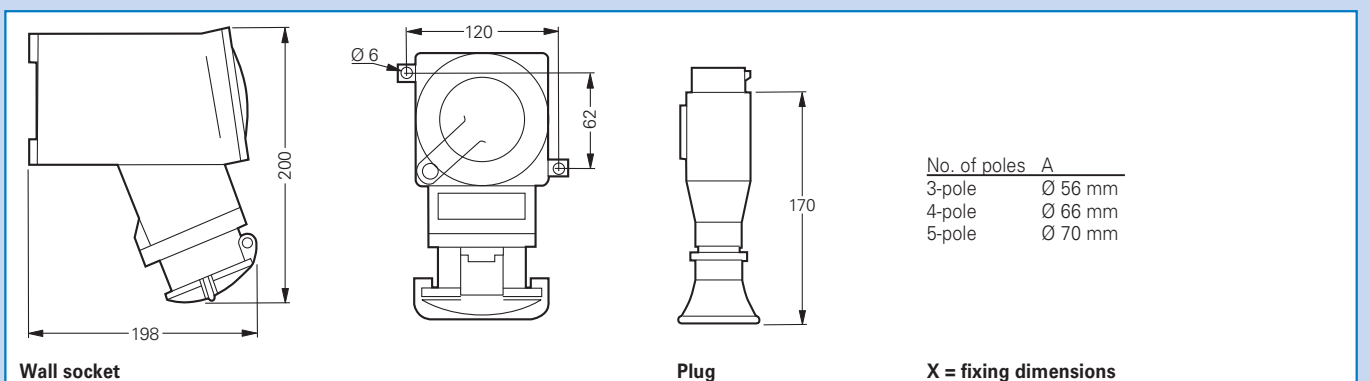

Dimensions in mm