

CONE DRIVE

5.000" C.D. **SIZE 50**

SINGLE REDUCTION

STANDARD HOLLOW GEAR SHAFT BORES

BORE INCHES	GEARSHAFT NUMBER	KEYWAY SIZE
3.4375*	50-S60-307	5/8 x 5/16
3.1875*	50-S60-303	5/8 x 5/16
2.750	50-S60-212	5/8 x 5/16

*AGMA Standard
Bore Tolerance: +.003, -.000
2 set screws at long extension end

NOTES:

Reducers may be used in floor, ceiling, or wall mounted positions, however they **must** be ordered for the position required so that suitable oil level, grease fittings, filler, and drains are provided. For cap and carrier dimensions not shown, see mounting section.

For steeple bearing arrangement see page 3-37.

All units can be motorized. See page 3-41. Motor adapter to be located at input shaft end of unit.

Fan cooling can be supplied on all units. See page 3-38.

When specified, units can be supplied with water cooling coils in oil sump. See page 3-36.

Set screw end of hollow shaft is considered the extension end.

All standard units are supplied with right-hand helix gears. Units are designed for shaft rotation in either direction. See page 3-44.

For additional available ratio's and left-hand helix gearing see tool charts in section 10.

Refer to section 2 for lubrication information.

IMPORTANT: It is the purchaser's or user's responsibility to guard all shafting in accordance with OSHA requirements.

AGMA HORSEPOWER & OUTPUT TORQUE RATINGS FOR 1.0 SERVICE FACTOR

RATIO TO 1		WORM RPM							
		100	200	300	580	720	870	1150	1750
5	Me.HP	7.21	13.20	18.20	27.60	31.00	34.30	39.60	47.40
	Th.HP	4.40	6.45	7.54	11.90	13.30	14.30	15.50	17.00
	O.T.	20900	19300	17800	14100	12800	11800	10300	8140
	C.P.	4343	2754	2175	1927	1972	1953	1978	2019
10	Me.HP	4.63	8.46	11.80	18.80	21.10	23.40	27.20	33.30
	Th.HP	3.80	5.44	6.95	9.65	10.50	11.20	12.10	12.90
	O.T.	25100	23400	22100	18400	16900	15500	13800	11200
	C.P.	7180	5898	4957	4048	3890	3776	3592	3261
15	Me.HP	3.25	5.96	8.36	13.30	15.00	16.70	19.30	23.80
	Th.HP	3.25	4.75	5.92	7.95	8.55	8.96	9.50	10.20
	O.T.	25200	23700	22300	19100	17600	16300	14400	11700
	C.P.	7180	7180	6395	5187	4888	4646	4308	3891
20	Me.HP	2.49	4.56	6.40	10.20	11.60	12.80	14.90	18.30
	Th.HP	2.49	4.21	5.23	7.00	7.47	7.82	8.15	8.50
	O.T.	24500	22900	21800	19000	17400	16000	14200	11600
	C.P.	7180	7180	7180	5873	5549	5285	4894	4380
25	Me.HP	2.01	3.67	5.16	8.27	9.34	10.30	12.00	14.80
	Th.HP	2.01	3.67	4.50	6.12	6.40	6.60	6.80	7.15
	O.T.	23600	22600	21800	18800	17300	16000	14300	11600
	C.P.	7180	7180	7180	6406	6073	5746	5318	4765
30	Me.HP	1.68	3.08	4.32	6.93	7.83	8.67	10.10	12.40
	Th.HP	1.68	3.08	3.88	5.30	5.57	5.77	5.92	6.12
	O.T.	22600	21300	20400	17600	16500	15400	13700	11100
	C.P.	7180	7180	7180	7006	6560	6220	5750	5141
40	Me.HP	1.27	2.32	3.25	5.22	5.90	6.53	7.58	9.34
	Th.HP	1.27	2.32	3.25	4.48	4.75	4.95	5.16	5.37
	O.T.	20400	19300	19200	17000	15800	14700	13100	10600
	C.P.	7180	7180	7180	7180	7180	6950	6423	5727
50	Me.HP	1.02	1.86	2.61	4.19	4.73	5.24	6.09	7.50
	Th.HP	1.02	1.86	2.61	3.74	3.94	4.15	4.42	4.75
	O.T.	18200	18500	18300	16700	15300	14200	12700	10300
	C.P.	7180	7180	7180	7180	7180	7180	6966	6208
60	Me.HP	0.85	1.55	2.18	3.50	3.95	4.37	5.08	6.26
	Th.HP	0.85	1.55	2.18	3.26	3.46	3.67	4.01	4.28
	O.T.	17900	18200	17600	15700	14600	13700	12200	9870
	C.P.	7180	7180	7180	7180	7180	7180	7180	6632
70	Me.HP	0.73	1.33	1.87	3.00	3.39	3.76	4.36	5.38
	Th.HP	0.73	1.33	1.87	3.00	3.26	3.40	3.67	3.80
	O.T.	17600	17900	17300	15500	14400	13500	12000	9760
	C.P.	7180	7180	7180	7180	7180	7180	7180	7180

Me.HP - Mechanical horsepower
Th.HP - Thermal horsepower

O.T. - Output torque in inch-lbs.
C.P. - Chain-pull in pounds

HAND OF ASSEMBLY FLOOR MOUNTED UNITS

When ordering, specify the assembly number required, selected from diagrams. (For ceiling and wall mounted units see page 3-42.) The hand of assembly is always determined as a floor mounted unit.

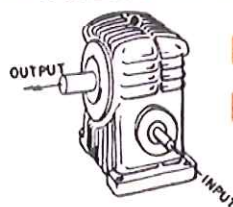
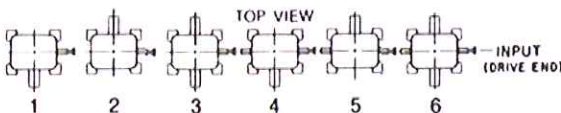

HO WORM OVER **SHO**
HU WORM UNDER **SHU**
1 SHOWN

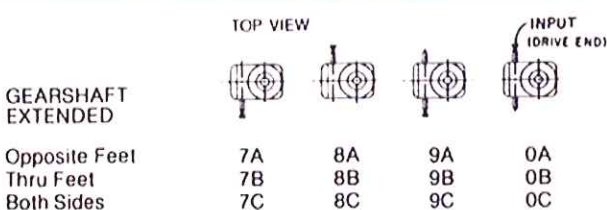
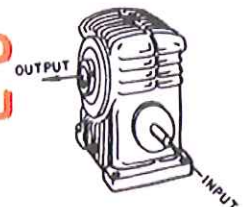

GEARSHAFT EXTENDED
Opposite Feet 7A 8A 9A 0A
Thru Feet 7B 8B 9B 0B
Both Sides 7C 8C 9C 0C



HV VERTICAL **SHV**
7A SHOWN

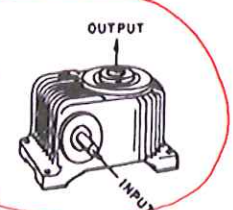

SIZE 50 5.000" C.D.

SOLID SHAFT

HOLLOW SHAFT

MODEL HO

WORM OVER GEAR

net wt 290 lbs

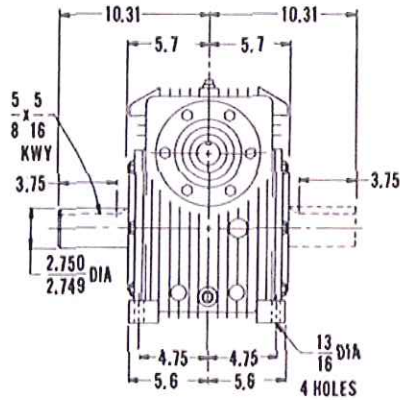
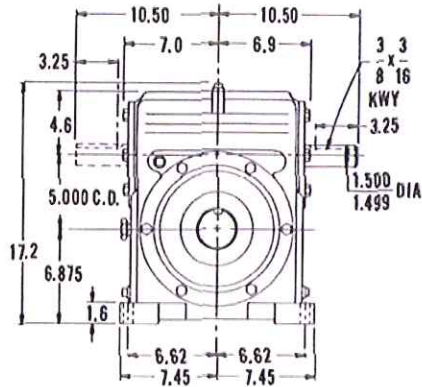

DASH LINE INPUT SHAFT INDICATES DOUBLE EXTENDED.
OUTPUT SHAFT MAY EXTEND ON EITHER SIDE OR MAY BE DOUBLE EXTENDED.

SHO

net wt 302 lbs

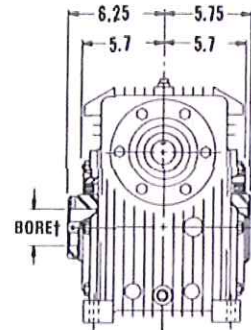

↑ SEE GEARSHAFT CHART
SET SCREW END OF SHAFT
MAY EXTEND ON EITHER SIDE.

MODEL HU

WORM UNDER GEAR

net wt 305 lbs

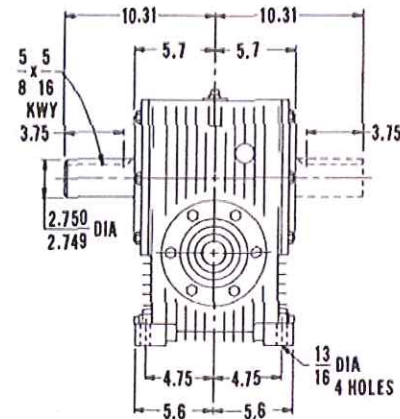
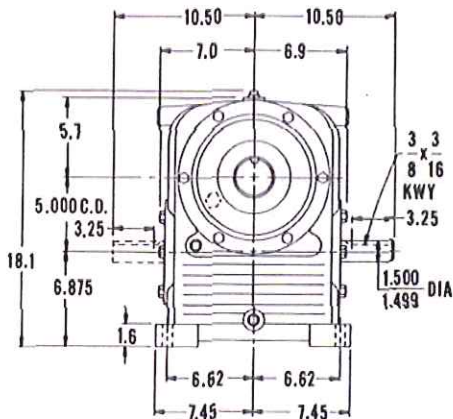

DASH LINE INPUT SHAFT INDICATES DOUBLE EXTENDED.
OUTPUT SHAFT MAY EXTEND ON EITHER SIDE OR MAY BE DOUBLE EXTENDED.

SHU

net wt 317 lbs

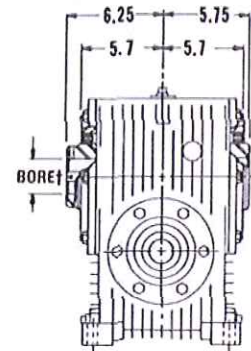

↑ SEE GEARSHAFT CHART
SET SCREW END OF SHAFT
MAY EXTEND ON EITHER SIDE.

MODEL HV

WORM HORIZONTAL
GEAR SHAFT VERTICAL

net wt 295 lbs

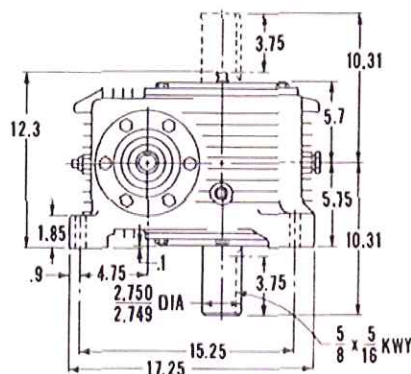
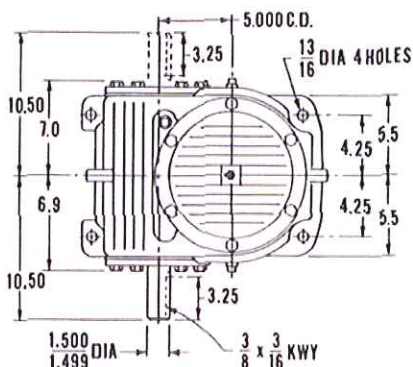

INPUT AND OUTPUT SHAFTS MAY EXTEND ON EITHER SIDE OR MAY BE DOUBLE EXTENDED

SHV

net wt 307 lbs

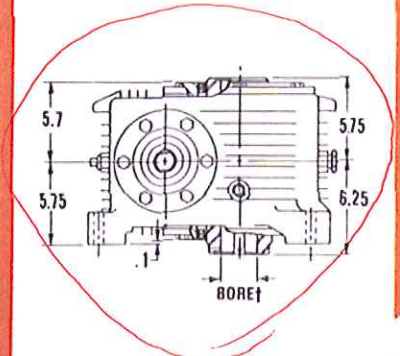

↑ SEE GEARSHAFT CHART
SET SCREW END OF SHAFT
MAY EXTEND ON EITHER SIDE.